

FIRST FLOOR

NEW AFRICAN MASQUERADES

CREATIVE CONCEPT STUDIO: WOMEN CULTIVATING LEGACY*

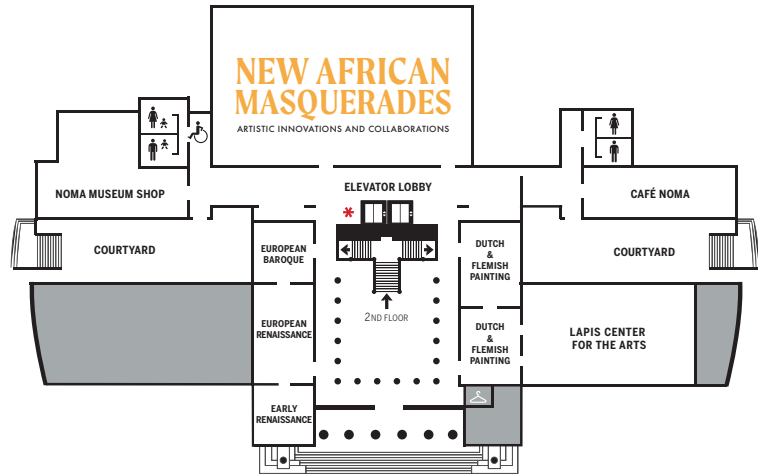

New African Masquerades includes contemporary pieces made with materials observed in African Art. Made from materials including wood, cloth and fabrics, sequins, feathers, gourds, raffia, and cowry shells, the ensembles on view represent a wide variety of masquerade practices and societies.

7. Find a colorful work, with a body made of raffia that has come to life with the application of dyes. It also has a helmet depicting images of cowrie shells, but not the shells themselves.

ARTWORK TITLE

ARTIST

8. Can you find another garment made with wood, fibers, and paint that is also worn to support and honor someone, but this time, to support a king? (Hint: It includes the image of a lizard and an icon from a famous scary movie!)

ARTWORK TITLE

ARTIST

9. Can you find the two artworks that often perform together as a pair? These two pieces also contain face masks, are made of fibers, but have the added elements of sequins, rhinestones, and lace!

ARTWORK TITLE

ARTIST

10. As you exit New African Masquerades and enter the Creative Concept Studio, can you find the artwork designed specifically for a secret women's society?

ARTWORK TITLE

ARTIST

BONUS What do the first mask discussed and the final mask discussed have in common?

ANSWERS 1) *Poros Society Horizontal Mask (Kpakalobi Sine)*, Loma artist, Liberia/Guinea border, Wood cotton, monkey fur, cowrie shells, feathers, leopard skin, metal, seeds 2) *Face Mask (muykeen)*, Kuba artist, Democratic Republic of the Congo, Glass beads, cowrie shells, raffia cloth, leopard skin 3) *King's Tunic (agbabalike)*, Yoruba artist, Igbu Region/Nigeria Glass beads and cloth 4) *Helmet Crest Mask*, Kom artist, Cameroon Wood, beads, polychrome 5) *When Black People Could Fly*, Elenora "Big Queen Rukiyah" Brown, United States Fabric, feathers, beads, plastic, cowrie shells, and thread 6) *Absorb*, Serge Attukwei Clottey, Ghana Plastics, wires, and oil paint 7) *Tightrope: Behind the Processor #2*, Elias Sime, from Ethiopia, active in Addis Ababa Woven electrical wires, circuit boards, and other components on panel 8) *Compromise Kimi Masquerade Ensembles Honoring Andre Sanou*, David Sanou, Burkina Faso Wood, fibers, glue, synthetic dyes, and paint 9) *Fairy and Oil Papa Masquerade Ensembles for the Jolly Society*, Sheku "Goldfinger" Fofanah with Abdullai "Bezo" Sesay, Sierra Leone Cotton and synthetic fibers, sequins, rhinestones, tassels, lace, synthetic wig, wood, paint, glue, thread, and rubber soles. 10) *Sande Society Helmet Mask (ndoli lowei or sowe)*, Sierra Leone and Liberia Wood and pigment

SPRING Festival

CELEBRATING

NEW AFRICAN MASQUERADES

ARTISTIC INNOVATIONS AND COLLABORATIONS

SCAVENGER HUNT

New Orleans Museum of Art

As you walk around the New Orleans Museum of Art, explore our African Art Gallery on the third floor, the *Afropolitan* exhibit on the second floor, and finally the *New African Masquerades* exhibition on the first floor. By completing the scavenger hunt below, you will visit all three exhibitions, discovering thematic and artistic relationships between many of these collections of artworks.

Record your answers on the lines provided by writing the title of the artwork and the artist.

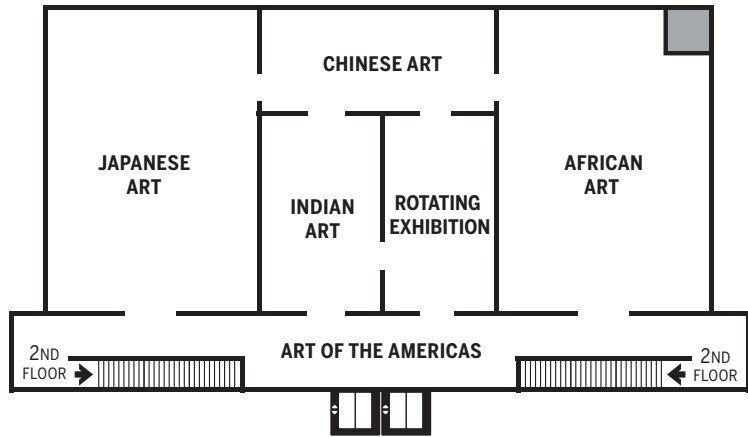

THIRD FLOOR/**AFRICAN ART**

The Poro Society is the secret society for men, responsible for initiating boys into manhood. They are secret in the sense that members of each society have certain knowledge that can only be shared with others within the community.

The Poro Society Horizontal Mask, *Kpakalogi Sinei*, which translates to “Big male,” is worn and performed for a variety of occasions. Note its materials, as you will be seeking similarities with other artworks within the museum.

Can you find the Poro Society Horizontal Mask?

1. Can you find another mask also made from cowrie shells and leopard skin? (Hint: It’s from the Democratic Republic of the Congo)

ARTWORK TITLE

ARTIST
2. Glass beads are used for more than just masks. Can you find a piece of clothing made from glass beads?

ARTWORK TITLE

ARTIST
3. The *King’s Tunic* showcases a variety of beads in different colors. Can you find a Helmet Mask that includes beautiful blue glass beads? (Hint: It’s from Cameroon)

ARTWORK TITLE

ARTIST

SECOND FLOOR/**AFROPOLITAN**

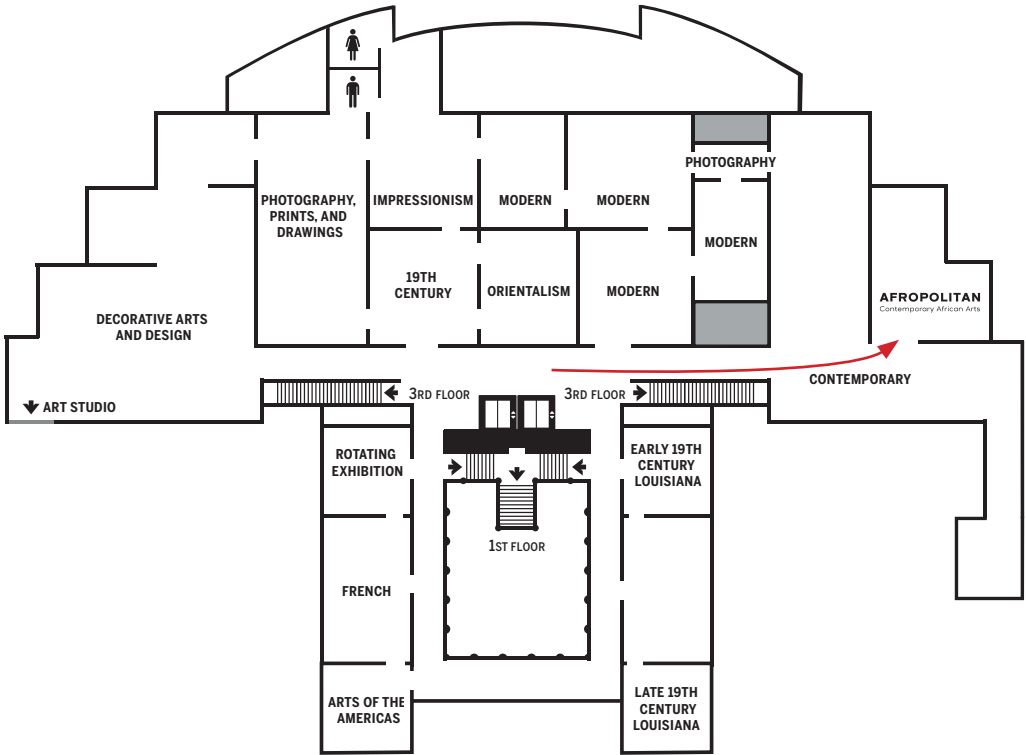

Much of African Art exhibits a mastery of working with beads, as you enjoy the work on the second floor of the New Orleans Museum of Art, consider the following:

4. Can you find a work of art that exhibits similar beadwork, as well as additional media, such as feathers, cowrie shells, and plastic? (Hint: It’s from New Orleans)

ARTWORK TITLE

ARTIST
5. Plastic can be used in a variety of ways when making art. Can you find a large-scale piece where the main material used is plastic?

ARTWORK TITLE

ARTIST
6. Can you find another large-scale piece that is also made from non-traditional materials?

ARTWORK TITLE

ARTIST